

LEVEL THREE

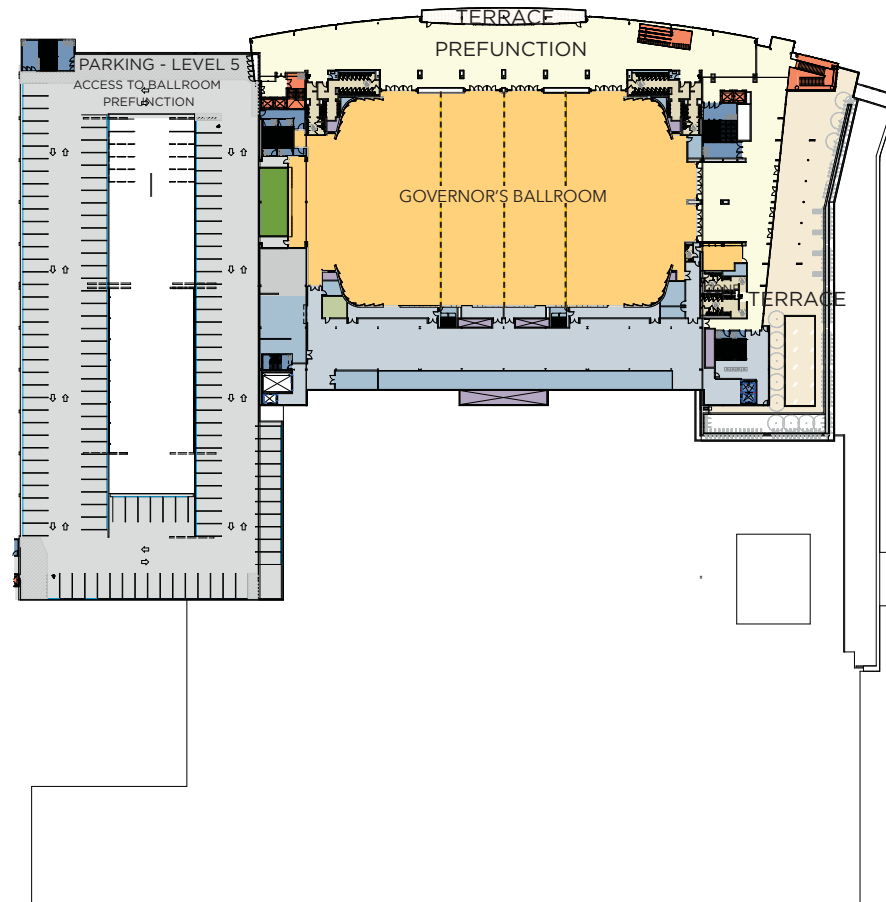

| ROOM NAME | DIMENSIONS | AREA | CEILING HEIGHT | THEATRE | CLASSROOM | BANQUET | CONFERENCE | U-SHAPE | HOLLOW SQUARE | RECEPTION |
|--------------------------------------|-----------------------|-----------|----------------|---------|-----------|---------|------------|---------|---------------|-----------|
| Governor's Board Room | 40 ft x 18 ft x 12' | 788 sf | 12 ft | 30 | 12 | 12 | 14 | 15 | 12 | 112 |
| Governor's Ballroom Prefunction | 381 ft x 40 ft x 24' | 13,583 sf | 24 ft | N/A | N/A | N/A | N/A | N/A | N/A | N/A |
| Governor's Ballroom Prefunction East | 161 ft x 51 ft x 20' | 6,813 sf | 19 ft | N/A | N/A | N/A | N/A | N/A | N/A | N/A |
| Governor's Ballroom | 144 ft x 242 ft x 30' | 39,850 sf | 30 ft | 3,326 | 1,479 | 2,688 | N/A | N/A | N/A | 5,692 |
| Governor's Ballroom A | 144 ft x 73 ft x 30' | 13,084 sf | 30 ft | 896 | 426 | 660 | 100 | 81 | 126 | 1,869 |
| Governor's Ballroom AB | 144 ft x 167 ft x 30' | 26,864 sf | 30 ft | 2,262 | 939 | 1,848 | N/A | N/A | N/A | 3,837 |
| Governor's Ballroom B | 144 ft x 90 ft x 30' | 13,780 sf | 30 ft | 1,022 | 474 | 720 | 100 | 93 | 138 | 1,968 |
| Governor's Ballroom BC | 144 ft x 167 ft x 30' | 26,864 sf | 30 ft | 2,262 | 939 | 1,848 | N/A | N/A | N/A | 3,837 |
| Governor's Ballroom C | 144 ft x 75 ft x 30' | 12,986 sf | 30 ft | 896 | 426 | 660 | 100 | 81 | 126 | 1,855 |