

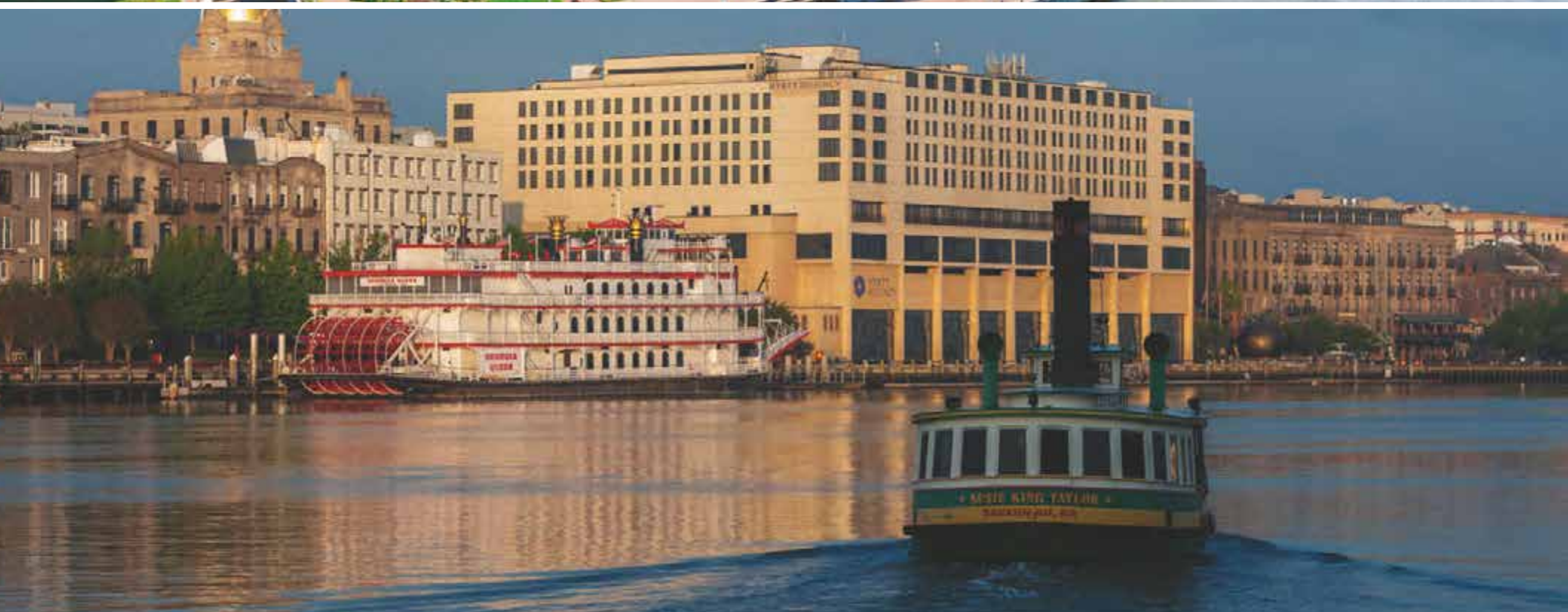

SAVANNAH
CONVENTION CENTER



EXPERIENCE THE

Savannah Convention Center

A unique and memorable venue for successful meetings, tradeshow or special events.

- Located on Hutchinson Island and the Savannah River
- Complimentary access via the Savannah Belles Water Ferry to the world-renowned historic district
- The Savannah Convention Center is adjacent to the Westin Savannah Harbor Golf Resort & Spa
- An abundance of unique lodging options located in the historic district

Catering with the Savannah Convention Center

The Savannah Convention Center hosts banquet and social events for groups of a few dozen to conventions of 10,000—and everything in between. In addition to large exhibit halls, the Savannah Convention Center has a spacious ballroom and meeting rooms to cater to any size group. Our award winning culinary staff will make every affair a memorable event. Catering services offered by the Savannah Convention Center span the full spectrum of catering needs.



FIRST FLOOR

- ? Information Kiosk
- Restrooms
- Service Area
- Elevators
- Stairs / escalators
- EE Emergency Exits
- ☎ House Phones
- Moveable Air Walls Or Roll Up Doors

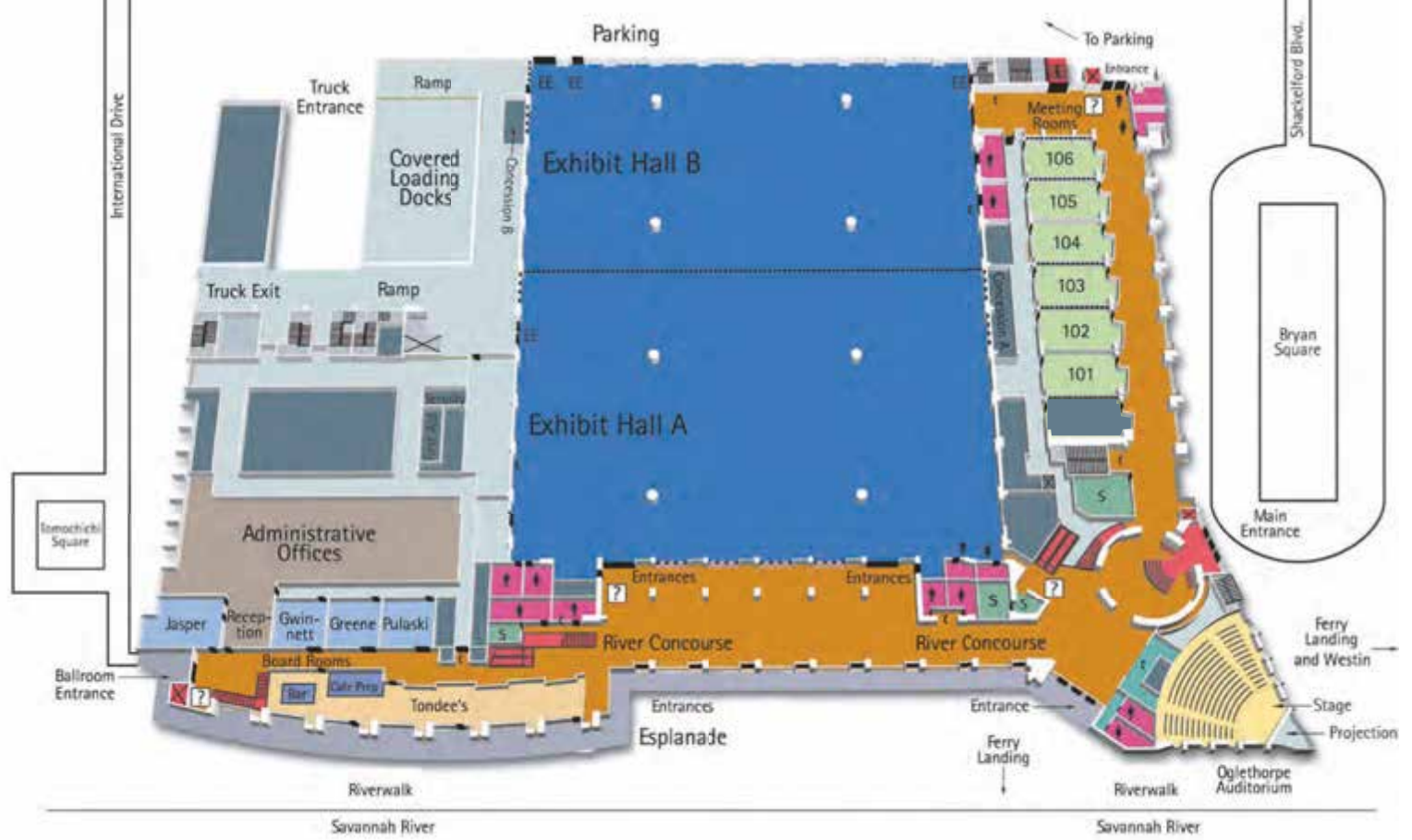

ROOM NAME	DIMENSIONS	AREA	CEILING HEIGHT	THEATRE	CLASSROOM	BANQUET	CONFERENCE	U-SHAPE	HOLLOW SQUARE	RECEPTION
Esplanade	143' x 649' x 20'	40,706 sf	0 ft	N/A	N/A	N/A	N/A	N/A	N/A	4288
Exhibit Hall	343' x 283' x 42'	96,110 sf	52.2 ft	9,669	2,987	6,220	N/A	N/A	N/A	10,116
Exhibit Hall A	193' x 283' x 42'	53,887 sf	52.2 ft	5,317	1,658	3,370	N/A	N/A	N/A	5,672
Exhibit Hall B	150' x 283' x 42'	42,223 sf	52.2 ft	4,395	1,264	2,420	N/A	N/A	N/A	4,444
River Concourse	279' x 69' x 16'	3,611 sf	34.9 ft	N/A	N/A	N/A	N/A	N/A	N/A	1,366
Greene Boardroom	24' x 29' x 10'	656 sf	14.6 ft	48	24	40	16	15	18	69
Gwinnett Boardroom	24' x 29' x 10'	656 sf	14.6 ft	48	24	40	16	15	18	68
Jasper Boardroom	46' x 28' x 12'	1,064 sf	12.9 ft	N/A	N/A	N/A	18	N/A	N/A	N/A
Pulaski Boardroom	24' x 29' x 10'	657 sf	14.6 ft	48	24	130	36	15	18	69
1st Floor East Concourse	298' x 48' x 16'	8,901 sf	47.8 ft	N/A	N/A	N/A	18	N/A	N/A	936
Meeting Room 101	51' x 30' x 14'	1,366 sf	13.9 ft	117	56	60	24	26	34	143
Meeting Room 102-104	51' x 90' x 14'	4,082 sf	13.9 ft	427	190	190	190	190	76	429
Meeting Room 102	51' x 30' x 14'	1,357 sf	13.9 ft	117	56	60	24	26	34	142
Meeting Room 102-103	51' x 60' x 14'	2,732 sf	13.9 ft	245	118	150	36	41	52	287
Meeting Room 103	51' x 30' x 14'	1,376 sf	13.9 ft	117	56	60	24	26	34	144
Meeting Room 103-104	51' x 60' x 14'	2,726 sf	13.9 ft	255	118	150	36	41	52	286
Meeting Room 104	51' x 30' x 14'	1,350 sf	13.9 ft	117	56	60	24	26	34	142
Meeting Room 105-106	51' x 57' x 14'	2,586 sf	13.9 ft	251	116	120	36	41	52	272
Meeting Room 105	51' x 30' x 14'	1,364 sf	13.9 ft	117	56	60	24	26	34	143
Meeting Room 106	51' x 27' x 14'	1,223 sf	13.9 ft	105	49	60	24	26	30	128
Oglethorpe Auditorium	70' x 94' x 8'	3,820 sf	25.9 ft	367	N/A	N/A	N/A	N/A	N/A	N/A

Features & Services

- 350 on-site parking spaces
- On-site docks for Savannah Belles Ferry providing service to River Street and Downtown
- Leed Gold Certified
- On-site audio visual company + Sponsorship branding internet
- G BAC Certified



MEETING & BOARD ROOMS

- 12 meeting rooms with flexible configurations
- 4 Board rooms
- 14' - 16' ceilings



RIVER CONCOURSE

- 3,600 sq. ft.
- Ideal for event registration and breaks
- Direct access to the riverfront Esplanade, Exhibit Hall and Tondees'



OUTDOOR SPACE

- Esplanade
- River Walk
- Gazebo
- Riverview Plaza



EXHIBIT HALLS

- 96,000 sq. ft.
- Divisible into two halls of 55,000 / 45,000 sq. ft.
- 52' ceilings
- 7.5' x 15' grid rigging point systems with 500 lb. capacity at each point
- Utilities every 30'
- Dual lighting system: halide & incandescent
- 45' x 27' hanger door



OGLETHORPE AUDITORIUM

- 367 seating capacity
- High quality sound system
- Translation capabilities
- Front and rear projection screens
- Wireless capacity
- User-friendly controls for lighting, shades, screens, and audio / visual functions



CHATHAM BALLROOM

- 25,000 sq. ft.
- Banquet seating for 1,100
- Expansive pre-function space
- Customizable lighting system
- View of Savannah River
- Two dressing rooms
- 30' ceilings
- 15' x 15' grid rigger point system with 500 lb. capacity at each point
- Freight elevator

Savannah Convention Center

Doubling In Size By Early 2024

Adding:

- 100,000 sf Exhibit Space with 2 Halls
- 40,000 sf Ballroom
- Ballroom Terrace
- 13 Meeting Rooms
- Parking Garage
- Eateries
- Prefunction Work Spaces



LEVEL THREE

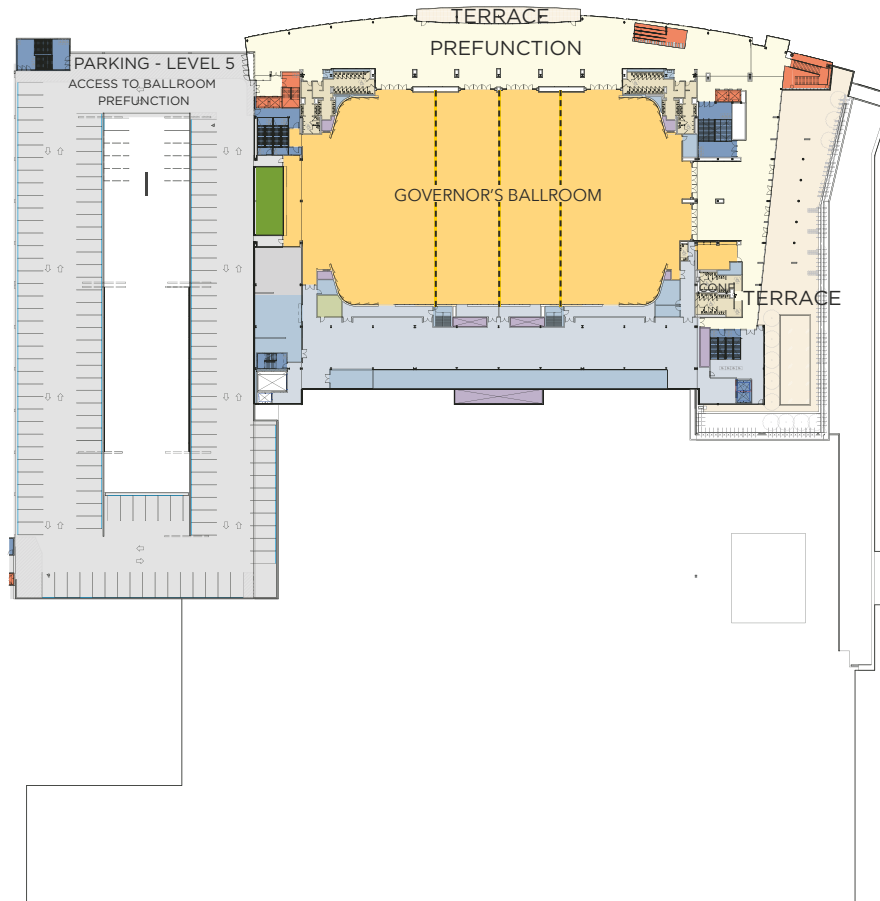

ROOM NAME	DIMENSIONS	AREA	CEILING HEIGHT	THEATRE	CLASSROOM	BANQUET	CONFERENCE	U-SHAPE	HOLLOW SQUARE	RECEPTION
Governor's Board Room	40 ft x 18 ft x 12'	788 sf	12 ft	30	12	12	14	15	12	112
Governor's Ballroom Prefunction	381 ft x 40 ft x 24'	13,583 sf	24 ft	N/A	N/A	N/A	N/A	N/A	N/A	N/A
Governor's Ballroom Prefunction East	161 ft x 51 ft x 20'	6,813 sf	19 ft	N/A	N/A	N/A	N/A	N/A	N/A	N/A
Governor's Ballroom	144 ft x 242 ft x 30'	39,850 sf	30 ft	3,326	1,479	2,688	N/A	N/A	N/A	5,692
Governor's Ballroom A	144 ft x 73 ft x 30'	13,084 sf	30 ft	896	426	660	100	81	126	1,869
Governor's Ballroom AB	144 ft x 167 ft x 30'	26,864 sf	30 ft	2,262	939	1,848	N/A	N/A	N/A	3,837
Governor's Ballroom B	144 ft x 90 ft x 30'	13,780 sf	30 ft	1,022	474	720	100	93	138	1,968
Governor's Ballroom BC	144 ft x 167 ft x 30'	26,864 sf	30 ft	2,262	939	1,848	N/A	N/A	N/A	3,837
Governor's Ballroom C	144 ft x 75 ft x 30'	12,986 sf	30 ft	896	426	660	100	81	126	1,855









What to do in Savannah

From music festivals to art exhibits, paddleboarding, kayaking, and evenings on the town, mild temperatures create the perfect setting for relaxation and revelry. To get the richest Savannah experience, take plenty of time to savor the city's fresh coastal cuisine and enjoy our culture. Park the car and get walking to discover one of the USA's greenest, most pedestrian-friendly cities. Tour 22 beautiful park-like squares draped in Spanish moss, stroll along River Street and take a trip to Savannah's beach town, Tybee Island.

Shopping

BROUGHTON STREET
CITY MARKET
RIVER STREET

SAVANNAH MALL
OGLETHORPE MALL
TANGER OUTLET MALL

Activities

NIGHT LIFE
DINING
TOURS
GOLF COURSES

TYBEE ISLAND
RIVER STREET
MUSEUMS
WATERSPORTS

Tybee Island

Tybee Island is only a 30-minute drive from the Savannah Convention Center, featuring beautiful mile-long beaches along the Georgia Coast. Enjoy beach activities such as kayaking, biking, fishing and much more. Tybee Island boasts three public oceanfront beaches and two river beaches, each appealing to a different kind of visitor. Be sure to check out the Tybee Lighthouse and area camping on the island.



Getting here is easy.

The Savannah Convention Center is easily accessible from most of the Southeast via two major interstates. It's also easy to reach from most of the country via the acclaimed Savannah / Hilton Head International Airport, which offers more than a dozen direct flights from major cities daily as well as Amtrak.

A 20 minute drive from the Savannah/Hilton Head International Airport via Interstate highways I-95 and I-16.

Getting to Savannah

BY AIR

Savannah / Hilton Head International Airport is only twenty minutes from the historic district of Savannah and is served by several major airlines including Delta, American Airlines, Frontier Airlines, Allegiant, JetBlue, United, Air Canada and Suncountry Airlines. Full complement of group transportation.

BY CAR

The Savannah Convention Center is easily accessible by car - only minutes from highways I-95 and I-16.

TRAIN

Amtrak Railroad Station located at 2611 Seaboard Coastline Drive Savannah, GA 31401

Getting Around Savannah

SAVANNAH BELLES FERRY

Connecting the Savannah Convention Center to River Street, Savannah Belles Ferry runs every 30 minutes, seven days a week, 7:00 am to midnight. For more information go to ConnectOnTheDot.com.

THE EXPRESS SHUTTLE

The Express Shuttle connects Savannah's Visitor Center parking facilities, shops, attractions, accommodations, and restaurants within the historic district; seven days a week, every 20 minutes from 9:00 am to 7:00 pm.

ALTERNATIVE TRANSPORTATION

You can find a friendly pedicab on most Savannah streets, or you can take advantage of our trolley and bus services, taxi, Uber, or Lyft.

31 Nonstop Destinations
 *Seasonal Service



VISIT
SAVANNAH
EST. 1733

SAVANNAH

Historic District
ILLUSTRATED

Savannah is the largest registered urban Historic Landmark District in the United States. It encompasses over 1,600 structures restored all within 2.2 square miles. Not only was she the state of Georgia's first city and capital, but America's first planned city utilizing the grid system and public squares.⁸⁰

East to:
Old Fort Jackson,
Fort Pulaski,
Tybee Island,
Lighthouse &
Beaches

Charles H. Morris Center
at Trustees' Garden

Eastern Wharf
Hotel

Homewood Suites
Savannah Hotel

Savannah Marriott
Riverfront

Tybee Island &
Atlantic Ocean

Hutchinson
Island

The Westin Savannah
Harbor Golf Resort & Spa

Savannah
Convention Center

Hutchinson
Island

Hutchinson
Island

Hutchinson
Island

Hutchinson
Island

Hutchinson
Island

South to:
Bonaventure
Cemetery,
Fort McAllister &
Wormsloe

Mother
Matilda Bensley
Park

South to:
Bonaventure
Cemetery,
Fort McAllister &
Wormsloe

South to:
Bonaventure
Cemetery,
Fort McAllister &
Wormsloe

South to:
Bonaventure
Cemetery,
Fort McAllister &
Wormsloe

South to:
Bonaventure
Cemetery,
Fort McAllister &
Wormsloe

South to:
Bonaventure
Cemetery,
Fort McAllister &
Wormsloe

South to:
Bonaventure
Cemetery,
Fort McAllister &
Wormsloe

South to:
Bonaventure
Cemetery,
Fort McAllister &
Wormsloe

South to:
Bonaventure
Cemetery,
Fort McAllister &
Wormsloe

South to:
Bonaventure
Cemetery,
Fort McAllister &
Wormsloe

South to:
Bonaventure
Cemetery,
Fort McAllister &
Wormsloe

South to:
Bonaventure
Cemetery,
Fort McAllister &
Wormsloe

South to:
Bonaventure
Cemetery,
Fort McAllister &
Wormsloe

South to:
Bonaventure
Cemetery,
Fort McAllister &
Wormsloe

South to:
Bonaventure
Cemetery,
Fort McAllister &
Wormsloe

South to:
Bonaventure
Cemetery,
Fort McAllister &
Wormsloe

South to:
Bonaventure
Cemetery,
Fort McAllister &
Wormsloe

Broughton Street blends Savannah's Southern charm and easy-going elegance with emerging trends of specialty retailers, chef-driven restaurants and fashion-forward drinkers. The beautiful architecture and historic buildings that line this natural artery provide the perfect backdrop for a memorable experience.

From trendy upscale shopping to antiques dealers, Broughton Street is Savannah's Fifth Avenue

Pedestrian access down to River Street is provided by numerous stairs and ramps located along Bay Street. Access is also provided by a public elevator located behind City Hall.

Savannah System shuttles charge
• EXPRESS 24 stop shuttle facilities
• SAVANNAH stroller, ferry & Hatcher
No part written Creative purpose
www.2019
©2019

MUSEUMS & ATTRACTIONS

- J-16 American Prohibition Museum
- D-13 Andrew Low House
- F-22 Battlefield Memorial Park
- D-9 Beach Institute
- I-3 Charles H. Morris Center at Trustees' Garden
- F-10 Colonial Park Cemetery
- G-20 Cultural Arts Center
- G-8 Davenport House Museum
- J-5 Emmet Park
- B-17 Forsyth Park
- D-12 Flannery O'Connor Home
- B-18 Georgia Historical Society
- C-22 Gilbert Civil Rights Museum
- E-16 Green-Meldrim House
- F-16 Harper-Fowlkes House
- H-16 Jepson Center for the Arts
- G-13 Juliette Gordon Low Birthplace
- A-11 King Tisdell Cottage Foundation
- B-14 Massie Heritage Center
- C-17 Mercer House Carriage Shop & Museum
- H-10 Owen-Thomas House and Slave Quarters
- F-24 Roundhouse Railroad Museum
- F-23 Savannah Children's Museum
- F-22 Savannah History Museum
- G-22 SCAD Museum of Art
- K-19 Ships of the Sea Museum
- E-15 Sorrel-Weed House
- I-16 Telfair Academy
- G-8 Webb Military Museum

LODGING

- M-17 Alida Hotel • 173 Rooms
- I-21 Aloft Hotel • 135 Rooms
- J-14 Andaz Savannah • 151 Rooms
- C-17 Armstrong House • 7 Rooms
- L-17 Best Western Plus Savannah • 89 Rooms
- K-13 Bohemian • 75 Rooms
- E-21 Cambria Suites Hotel • 103 Rooms
- L-20 Comfort Suites Hotel • 76 Rooms
- K-14 Cotton Sail Hotel • 75 Rooms
- E-21 Courtyard Savannah Downtown • 156 Rooms
- K-18 DoubleTree Hotel Savannah • 150 Rooms
- J-10 Drayton Hotel • 50 Rooms
- J-8 East Bay Inn • 28 Rooms
- H-1 Eastern Wharf Hotel • 300 Rooms
- H-23 Embassy Suites Savannah • 150 Rooms
- I-20 airfield Inn & Suites • 140 Rooms
- J-8 J-8 Hampton Inn Historic District • 144 Rooms
- H-21 Hampton Inn & Suites Savannah • 154 Rooms
- K-16 Hilton Garden Inn Savannah • 133 Rooms
- J-9 Holiday Inn Express Savannah • 143 Rooms
- K-19 Holiday Inn Savannah • 143 Rooms
- I-2 Homewood Suites Savannah Hotel • 164 Rooms
- L-12 Hyatt Regency Savannah • 351 Rooms
- K-15 Hotel Indigo • 252 Rooms
- N-17 JW Marriott Hotel • 419 Rooms
- I-4 Kimpton Brice Hotel • 145 Rooms
- J-7 Lark Hotel • 55 Rooms
- A-16 Mansion on Forsyth Park • 126 Rooms
- H-11 Marshall House • 65 Rooms
- J-4 Olde Harbour Inn • 24 Rooms
- E-13 Perry Lane Hotel • 167 Rooms

- I-10 Planters Inn • 60 Rooms
- L-16 Quality Inn Heart of Savannah • 170 Rooms
- E-22 Residence Inn Savannah Downtown • 108 Rooms
- K-9 River Street Inn • 86 Rooms
- I-1 Savannah Marriott Riverfront • 391 Rooms
- H-18 Springhill Suites Marriott • 162 Rooms
- J-7 Staybridge Suites Savannah • 104 Rooms
- D-14 The Desoto Hotel • 246 Rooms
- H-24 Thunderbird Inn • 42 Rooms
- E-20 Tryp by Wyndham • 62 Rooms
- A-16 West Elm Hotel • 93 Rooms
- M-3 Westin Savannah Harbor Golf Resort • 403 Rooms



LEGEND

- Lodging
- Museums & Attractions
- Broughton St. Shopping
- Express Forsyth Loop Shuttle
- Express Downtown Loop Shuttle
- Water Taxi Route
- SHUTTLES: Get on and off at any of two stops around the Historic District via two express loops. Connects to municipal parking lots, Ferry, and Visitor Centers.
- SAH BELLIES FERRY: These bicycle and pet-friendly water taxis provide passenger service between River Street and Hutchinson Island.
- This design may be reproduced without permission from the publisher Karpovage Creative, Inc. This map is intended for illustrative purposes only and is not to scale.
- Map exclusively for Visit Savannah by: Michael Karpovage michael@karpovagecreative.com karpovagecreative.com Karpovage Creative, Inc. All rights reserved.

North to: Hutchinson Island, South Carolina & Hilton Head





One International Dr. • Savannah, GA 31421 • **p** (912) 447-4000 • **f** (912) 447-4722
www.savconventioncenter.com